

---

---

## Pantera Electronics Tachometer Interface (adapter) Installation Manual

---

---

### ***Tachometer Adapter Features and Benefits:***

1. Converts ignition system pulse to trigger for Veglia tach or factory vintage tachs.
2. Compatible with ignition systems or ECU's.
3. Tach Adapter accepts signals from ignition systems , ECU's and digital distributors.
4. Additional control wire for a relay to control fuel pumps or electric carburetor chokes or anything that needs to be activated when the engine is rotating.
5. Includes a color integrated LED bargraph display as a RPM reference tachometer, 1,000 to 10,000 RPM in 1000 RPM increments.
6. Blue indicator for input pulse from distributor or ignition system and ECU's.
7. Green power "ON" or ready indicator.
8. Replaces MSD 8920 wire for wire.



### ***WARNING !***

***This device generates high voltage on the blue wire. Any time the engine is operating there is a shock hazard by touching the blue wire or anything it is connected to.***

**NOTE:** It's important to keep this installation manual for future reference since revisions to this product change the contents of the installation manual.

## Connections and Indicators for Tachometer Adapter

Blue indicator for pulses from distributor or ignition system.  
The blue indicator will flash when starting the engine and flash faster as the engine transitions from start to idle.

10 LED indicators for engine RPM in increments of 1,000 RPM.  
As the RPM increases the next light will gradually illuminate about 200 RPM before the full brightness at the indicated RPM.

Green indicator power "ON".  
The green indicator is illuminated when the ignition is "ON"

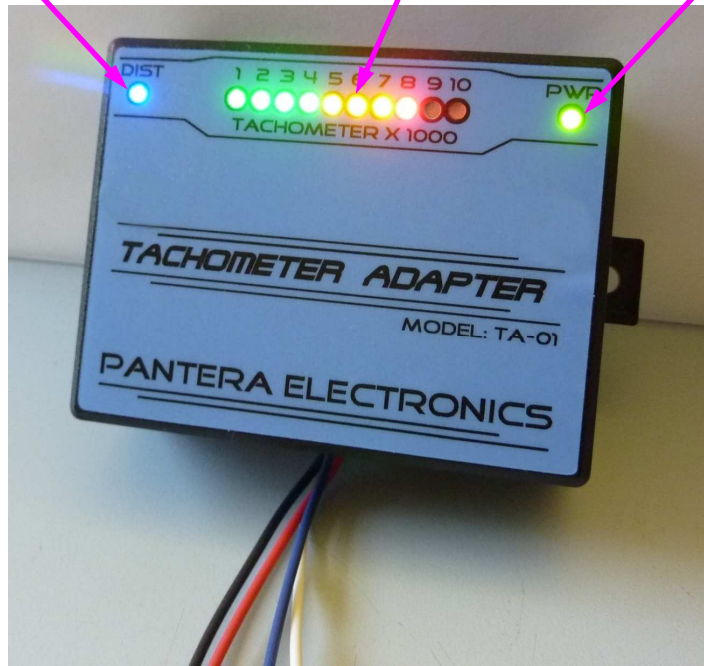

RED wire - connect to +12V when the ignition switch in the "RUN" position.

BLACK wire - connect to chassis ground.

WHITE wire - connect to the ignition system that is generating pulses.

BLUE wire - connect to the tachometer trigger wire. (**WARNING - HIGH VOLTAGE**)

YELLOW wire - connect to a relay to control fuel pump or choke.  
(output can supply +12V to a maximum of 1 Amp.)

Wiring the Tach Adapter (*Model - 1*) for ignition system to vintage tachometer. (including de Tomaso Pantera Veglia tachometer)

Dark Blue WIRE in engine bay is the tach wire. **(WARNING - HIGH VOLTAGE)**  
 Connect the dark blue wire in the engine bay to the blue wire of the Tach Adataper

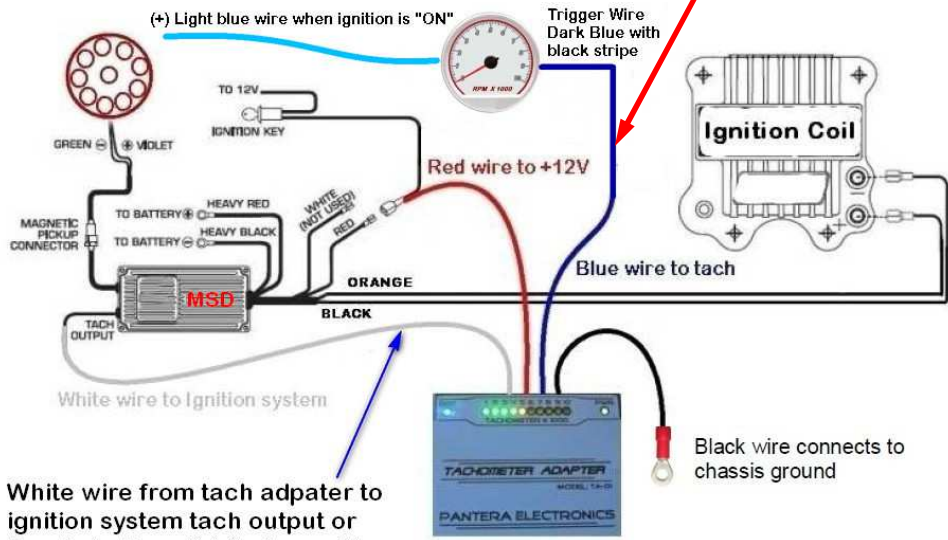

White wire from tach adapter to ignition system tach output or Ready-to-Run distributors with GREY wire.

Tachometer Adapter wiring for Fuel Pump Control  
 (fuel pump operates only when engine is rotating)

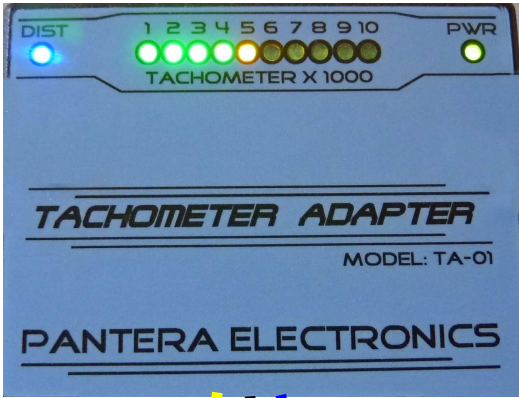

Red wires connects to +12V ignition "ON"

Blue wire connects to tach trigger.

**WARNING  
HIGH  
VOLTAGE**

Fuse Panel

Black wire connects to chassis ground.

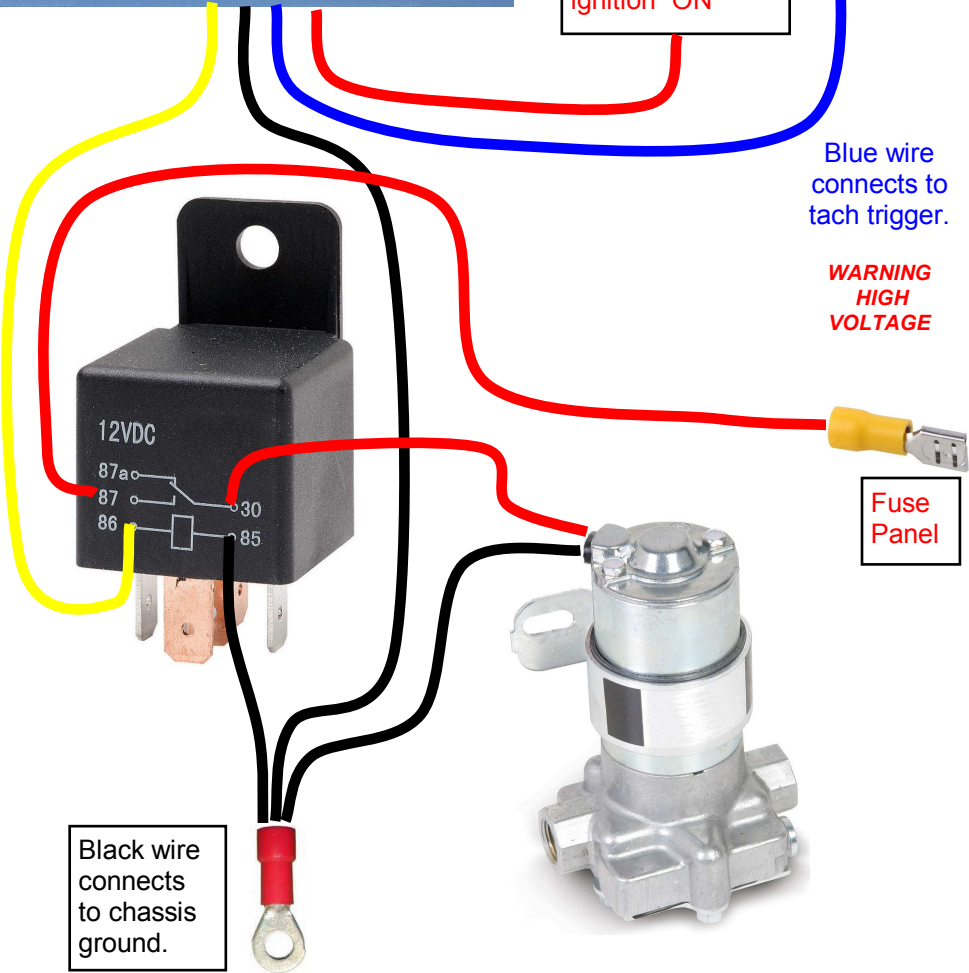

### Mounting Dimensions

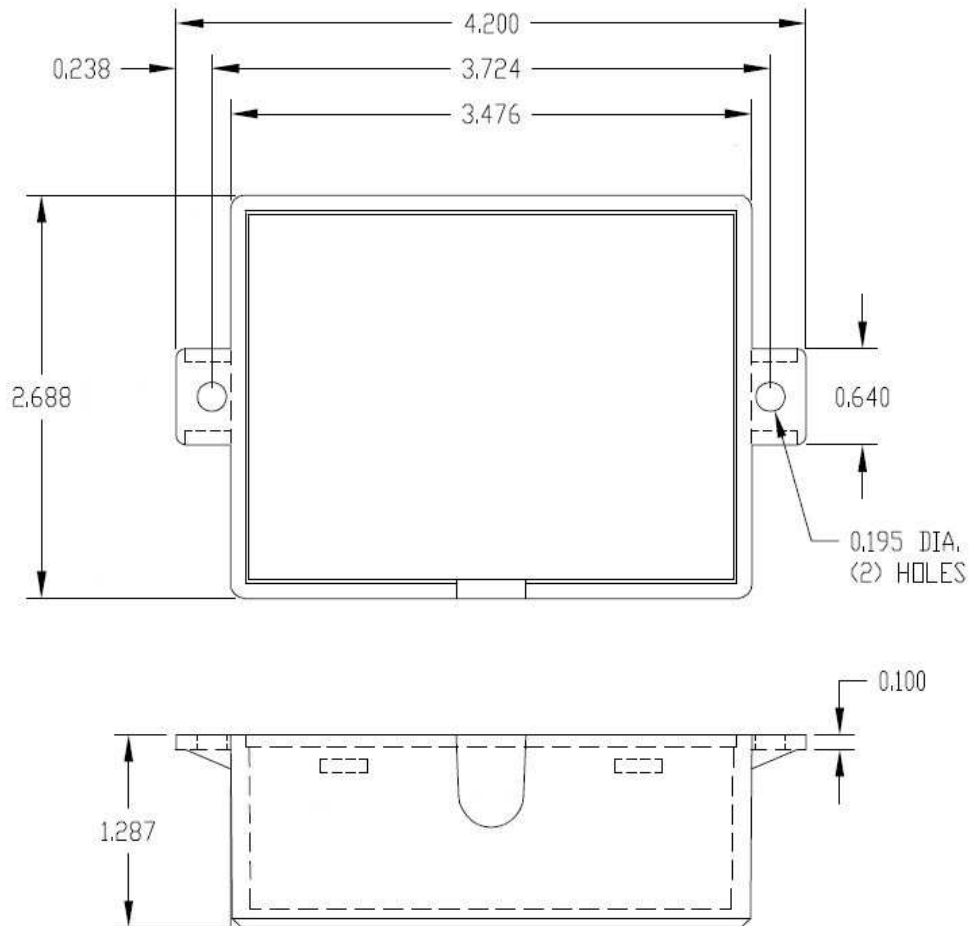

### Disclaimer

The products from Pantera Electronics have been designed and manufactured with the best quality components known to the engineer. The installation instructions have been written to assist the owner in the proper use and installation of the products. Pantera Electronics can not be held responsible or held liable for the interpretation or incorrect implementation of the products.





—

—